

 Crafted in Switzerland

PC-6

THE WORLD'S LEADING STOL
MODEL BUILDING PLAN 1:25



 **PILATUS** 

PC-6

MODEL BUILDING PLAN 1:25

The Pilatus Porter PC-6 has become a legendary aircraft, known around the world simply as "The Porter". Its unique short take-off and landing (STOL) capabilities, reliability and versatility in all weather and terrain conditions have established the reputation of the PC-6 as a rugged utility aircraft.

The Porter is fully capable of operating from different types of unprepared, rough and short airstrips, in remote areas, at high altitudes and in all climates. A simple but solid construction, proven systems and features, combined with precision workmanship result in the highest reliability and lowest maintenance possible. No matter whether high and hot or low and snow - anywhere, anytime you can rely on the PC-6 as a high quality, life-long investment.

PERFORMANCE

The PC-6/B2-H4 has the following performance under international standard atmospheric (ISA) conditions:

Take-off distance over 50 ft (15 m) obstacle (STOL)	1,444 ft	440 m
Landing distance over 50 ft (15 m) obstacle (STOL)	1,033 ft	315 m
Max. rate of climb (MTOW)	1,010 ft/min	5.13 m/sec
Max. cruise speed	125 KTAS	232 km/h
Max. range		
- at 10,000 ft	500 nm	926 km
- with underwing tanks	870 nm	1,611 km
Max. certified altitude	25,000 ft	7,620 m
Stall speed (MTOW)		
- flaps up (V_s)	58 KEAS	107 km/h
- full flaps set (V_{s0})	52 KEAS	96 km/h

WEIGHTS

Basic operating weight ¹	2,756 lb	1,250 kg
Max. take-off weight	6,173 lb	2,800 kg
Max. landing weight	5,863 lb	2,660 kg
Max. payload ¹	up to approx. 2,646 lb	1,200 kg
Payload with full fuel ¹	up to approx. 2,381 lb	1,080 kg

¹ Depending on configuration and fuel

DIMENSIONS

Wing Span	52 ft 1 in	15.87 m
Length	35 ft 9 in	10.9 m
Height	10 ft 6 in	3.20 m

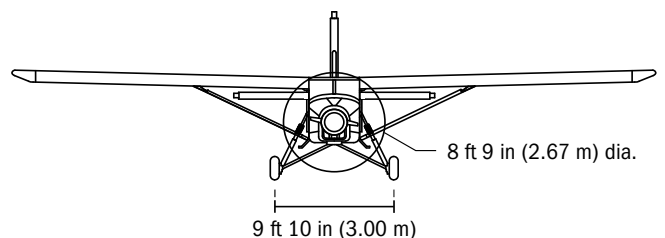
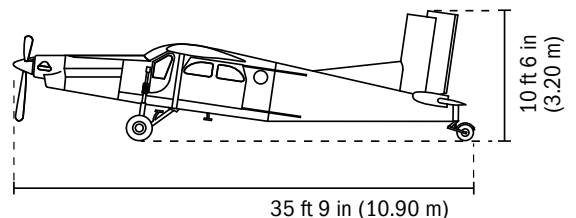
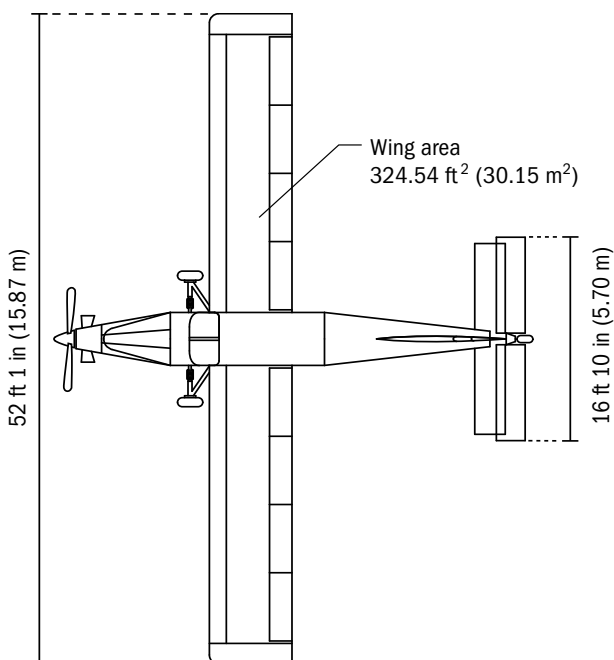
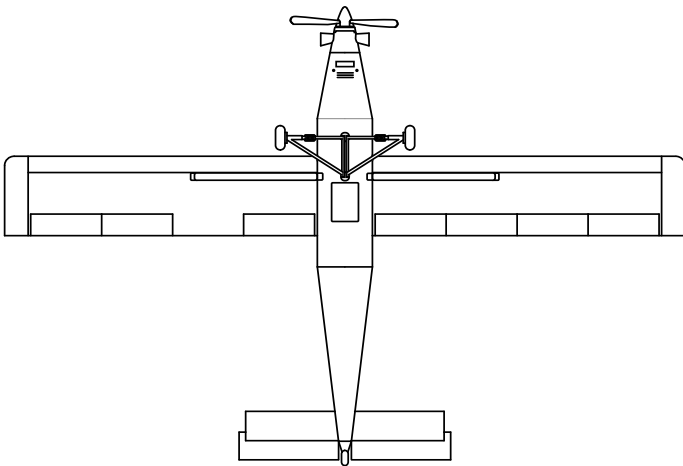

PC-6

STICKERS

STATIC PRESSURE
KEEP CLEAR

FIRST AID KIT
INSIDE

STATIC PRESSURE
KEEP CLEAR

FIRST AID KIT
INSIDE

DO NOT PUSH
DO NOT PUSH
DO NOT PUSH
DO NOT PUSH
DO NOT PUSH
DO NOT PUSH
JACK UP HERE

LIFT HERE
JACK UP HERE
LIFT HERE
JACK UP HERE

FUEL:
ASTM- D-1655 JET A, JET A-1 AND JET B
(PWA 522 AND CPW 46 SPECS)
USABLE CAPACITY
322 LTR. 85 US. GAL.

FUEL SYSTEM
WATER DRAIN

JACK UP HERE

JACK UP HERE
TURN SLIDE
TURN SLIDE

CLOSED
TURN PULL
TURN PULL
OPEN
OPEN

PULL TURN SLIDE
PULL AND TURN
PULL TURN SLIDE
PUSH TO OPEN

TYRE 47 PSI (3,2 bar)

PRESSURE 348 PSI
(24 bar)

OIL LEVEL 316 mm

OIL LEVEL

OIL LEVEL

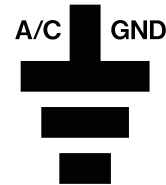

HYDR. FLUID
MIL - H - 5606

HYDR. FLUID
MIL - H - 5606

MAX LOAD
ON TRAP DOORS
TOTAL 300 kg 660 lbs

110.70.06.855

MAXIMUM AIRCRAFT WEIGHT: 1500 kg (3307 lbs)
COMPUTE WT OF AIRCRAFT PRIOR TO HOISTING

ENVIRONMENTAL PROTECTION
WHEN DRAINING FUEL USE THIS
BOTTLE FOR WATER CONTENT TEST

FUEL:

ASTM - D - 1655 JET A , JET A - 1 AND JET B
(PWA 522 AND CPW 46 SPECS)

USABLE CAPACITY
243 LTR. 64 US. GAL.
GROSS WEIGHT
220 KG. 485 LBS.

FUEL:

ASTM - D - 1655 JET A , JET A - 1 AND JET B
(PWA 522 AND CPW 46 SPECS)

USABLE CAPACITY
243 LTR. 64 US. GAL.
GROSS WEIGHT
220 KG. 485 LBS.

ENGINE FUEL
DUMP DRAIN

CLOSED
CLOSED
OPEN



24 VOLT DC

1.4 bar
1.4 bar

FUEL FILTER ACCESS
REMOVE WITH TANK EMPTY

FUEL FILTER ACCESS
REMOVE WITH TANK EMPTY

FUEL SYSTEM
WATER DRAIN

FUEL SYSTEM
WATER DRAIN

OPEN THIS DOOR FIRST

TRESTLE HERE TRESTLE HERE
TRESTLE HERE TRESTLE HERE
TRESTLE HERE TRESTLE HERE

TRESTLE HERE TRESTLE HERE
TRESTLE HERE TRESTLE HERE
TRESTLE HERE TRESTLE HERE
TRESTLE HERE TRESTLE HERE
TRESTLE HERE TRESTLE HERE

ELT
INSTALLED INSIDE

PC-6

DETAILED VIEW

NOSE



TAIL & ANTENNA



GEAR



GEAR



WING LANDING LIGHTS



FLAP SYSTEM



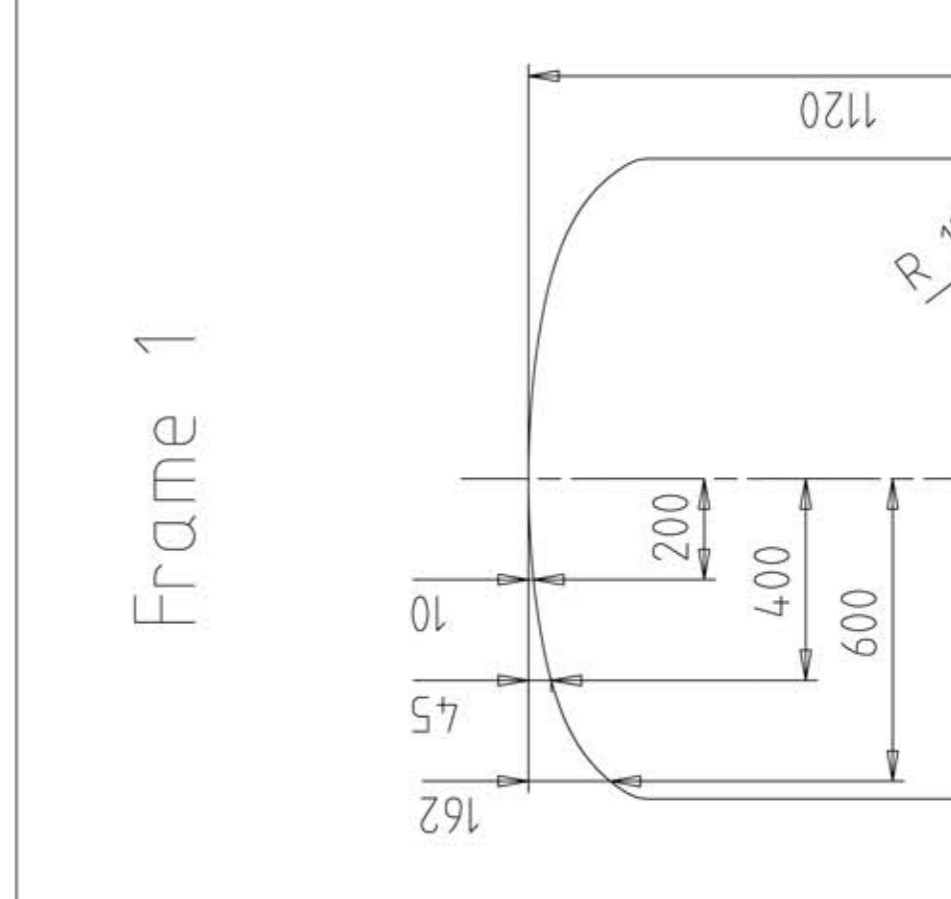
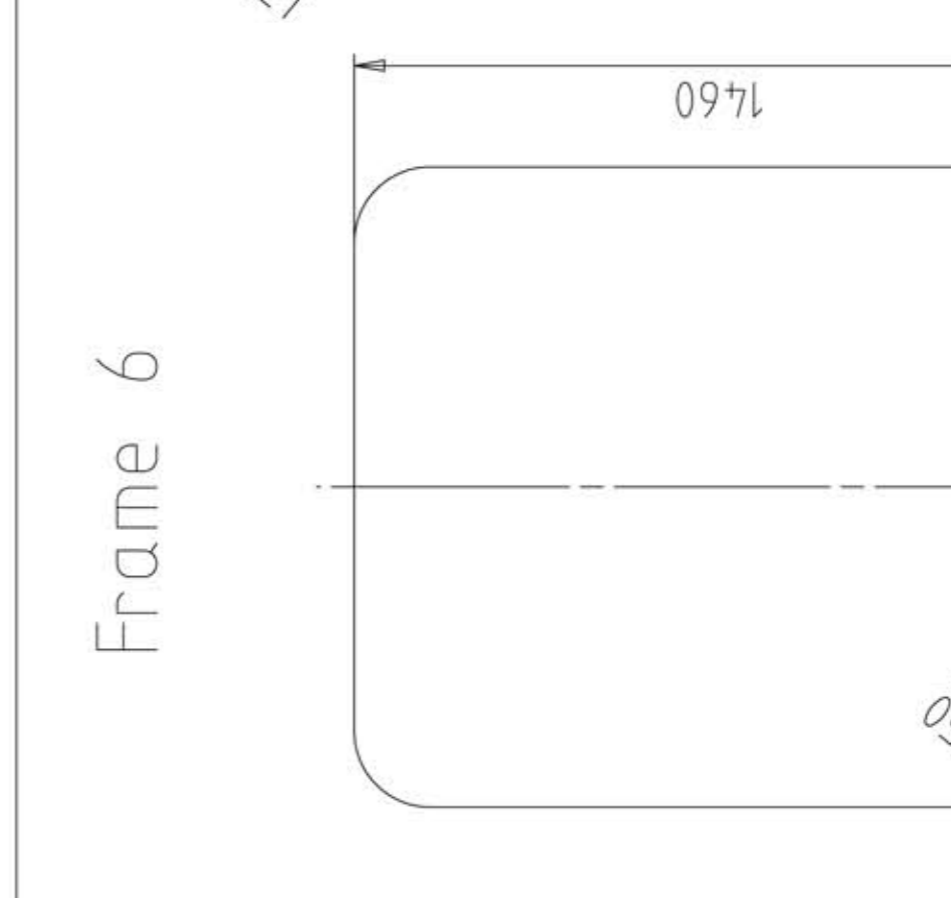
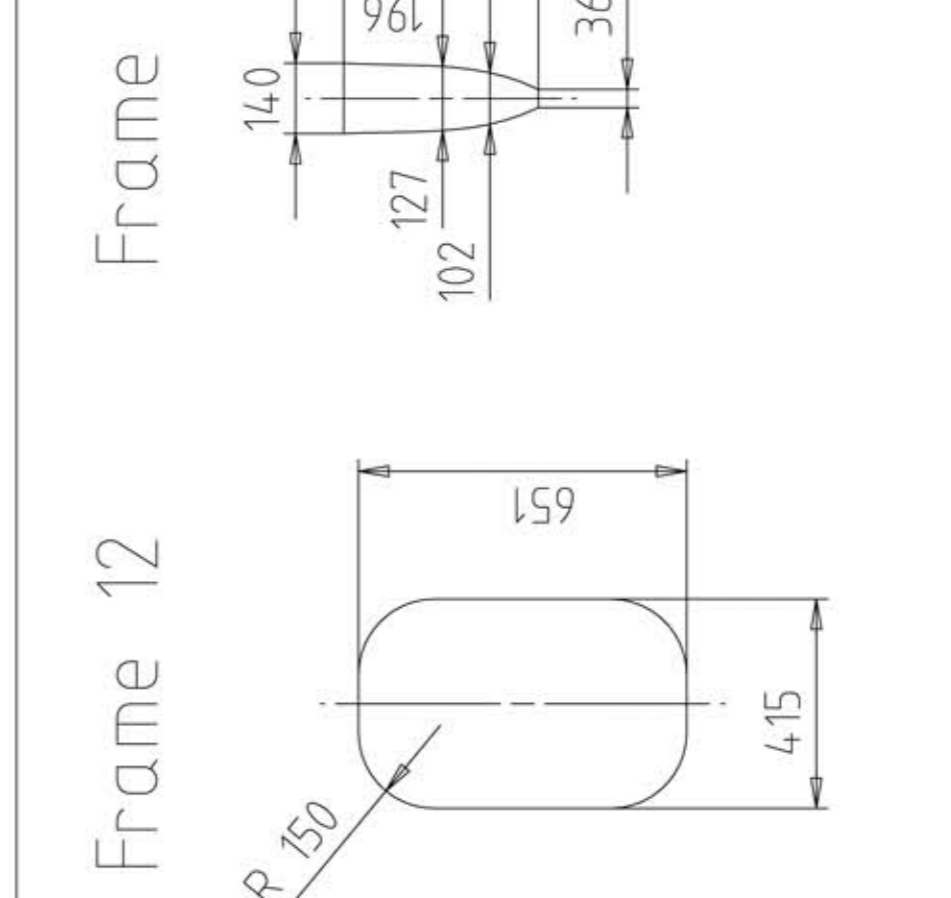
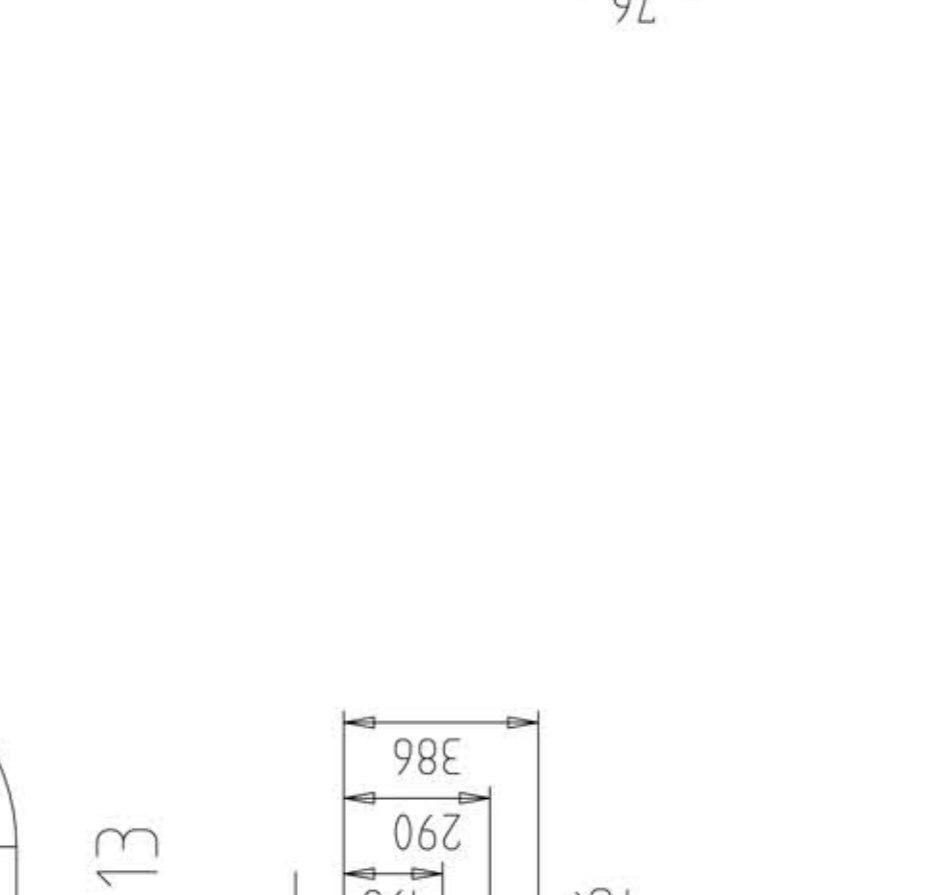
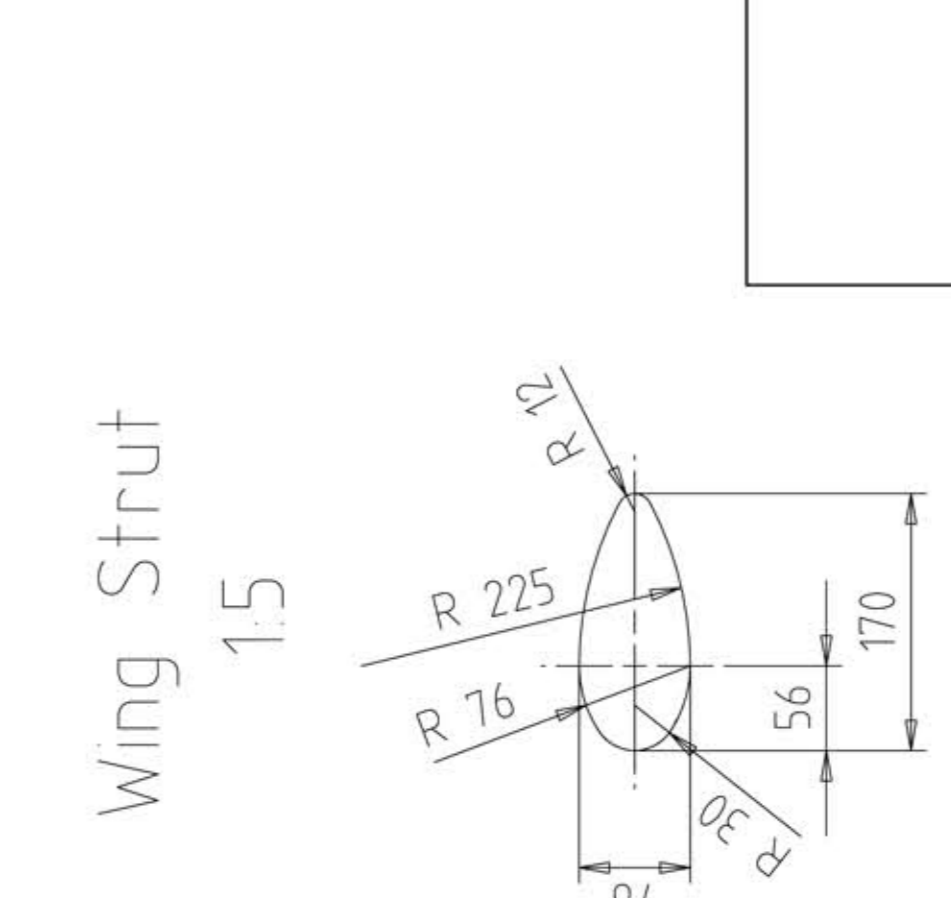
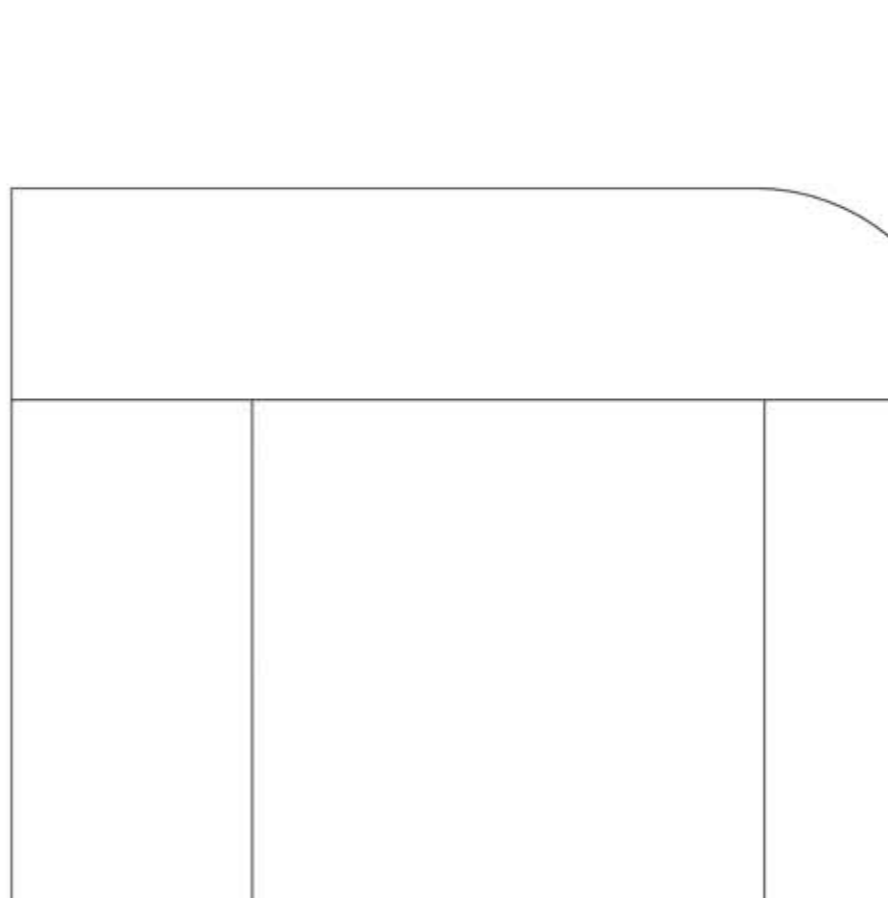
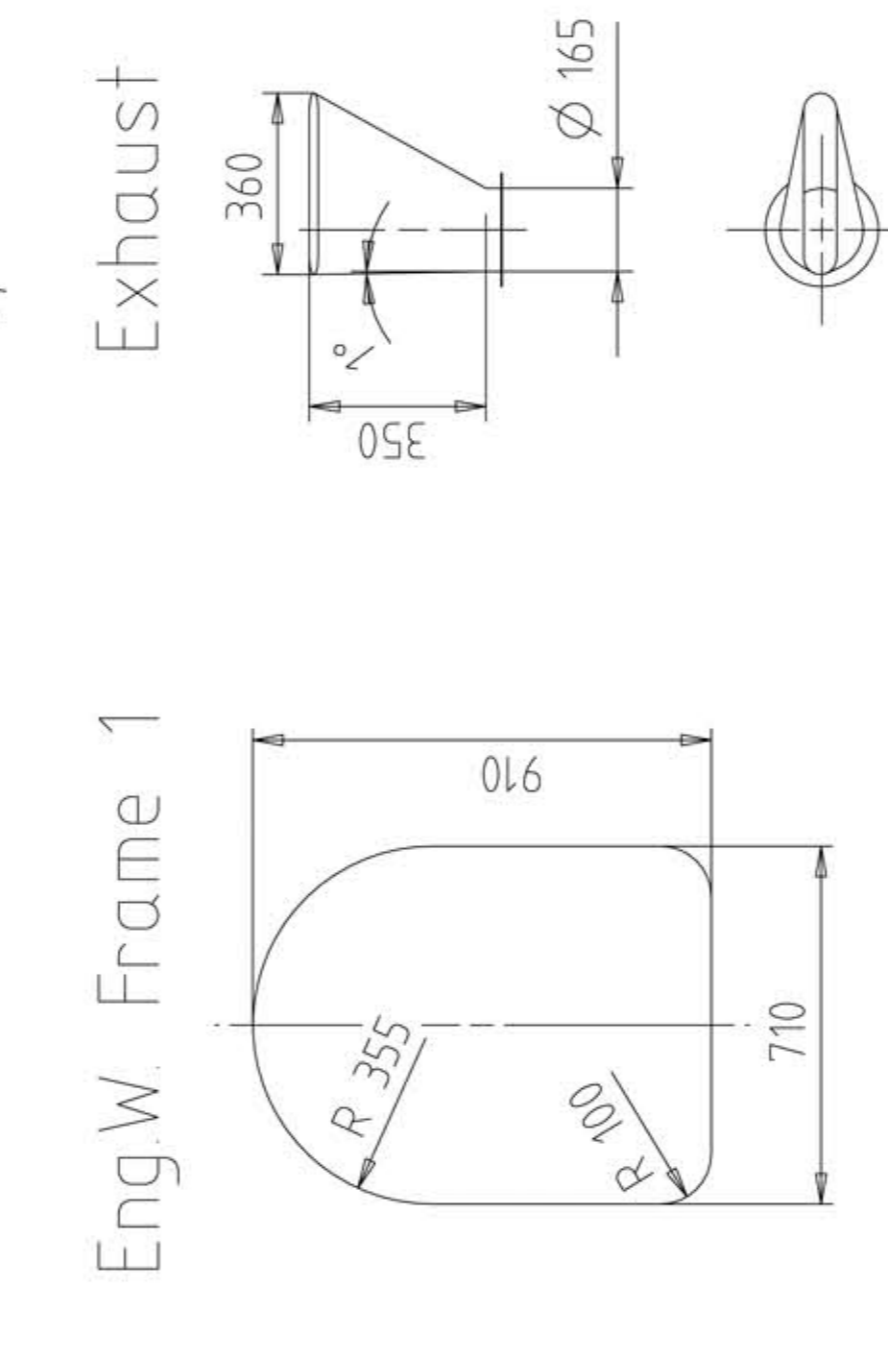
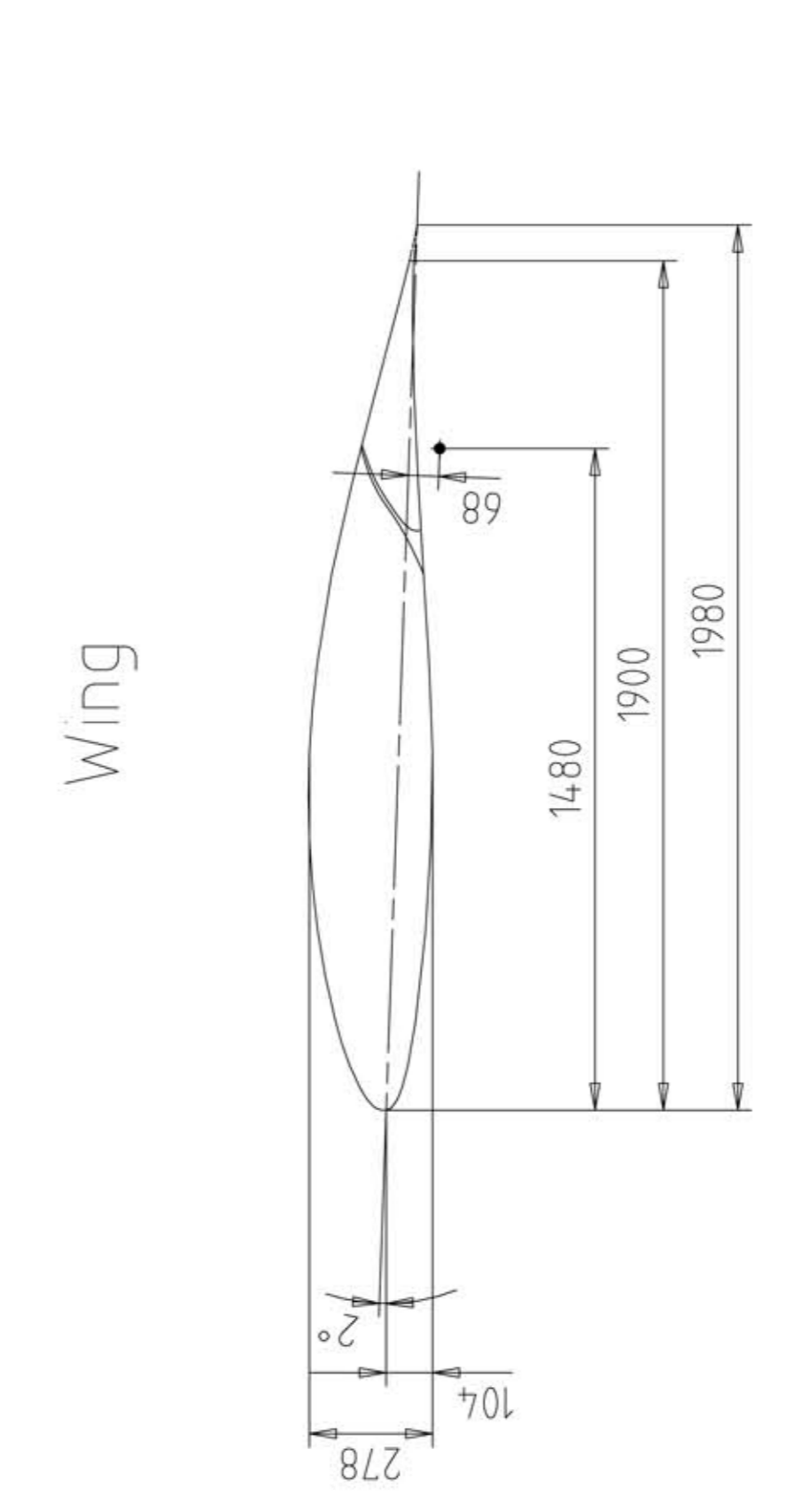
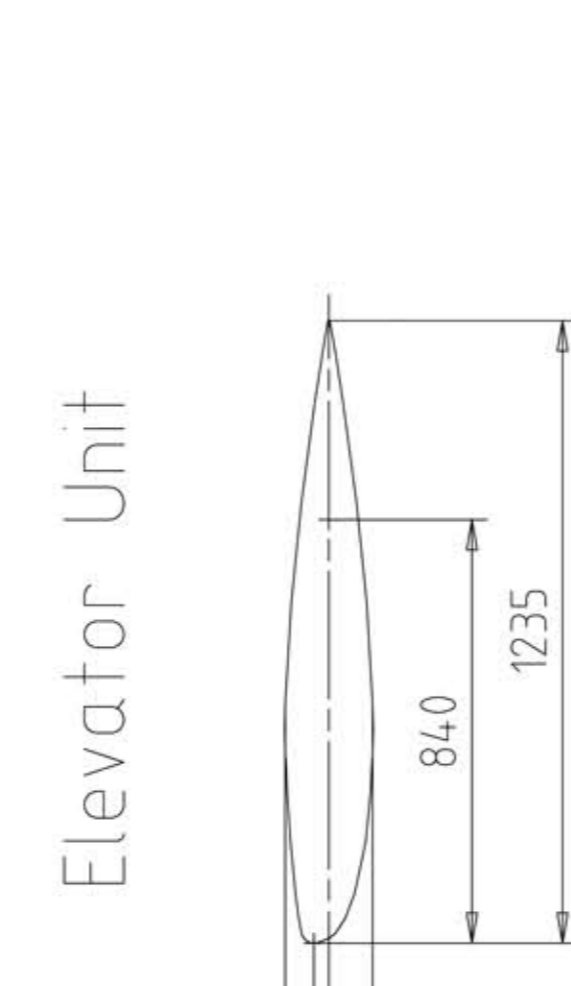
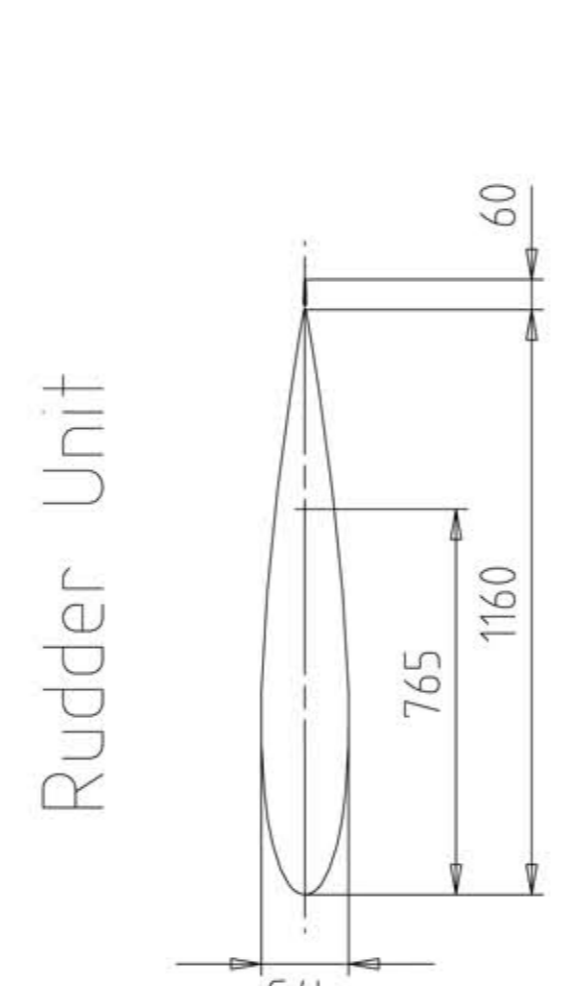
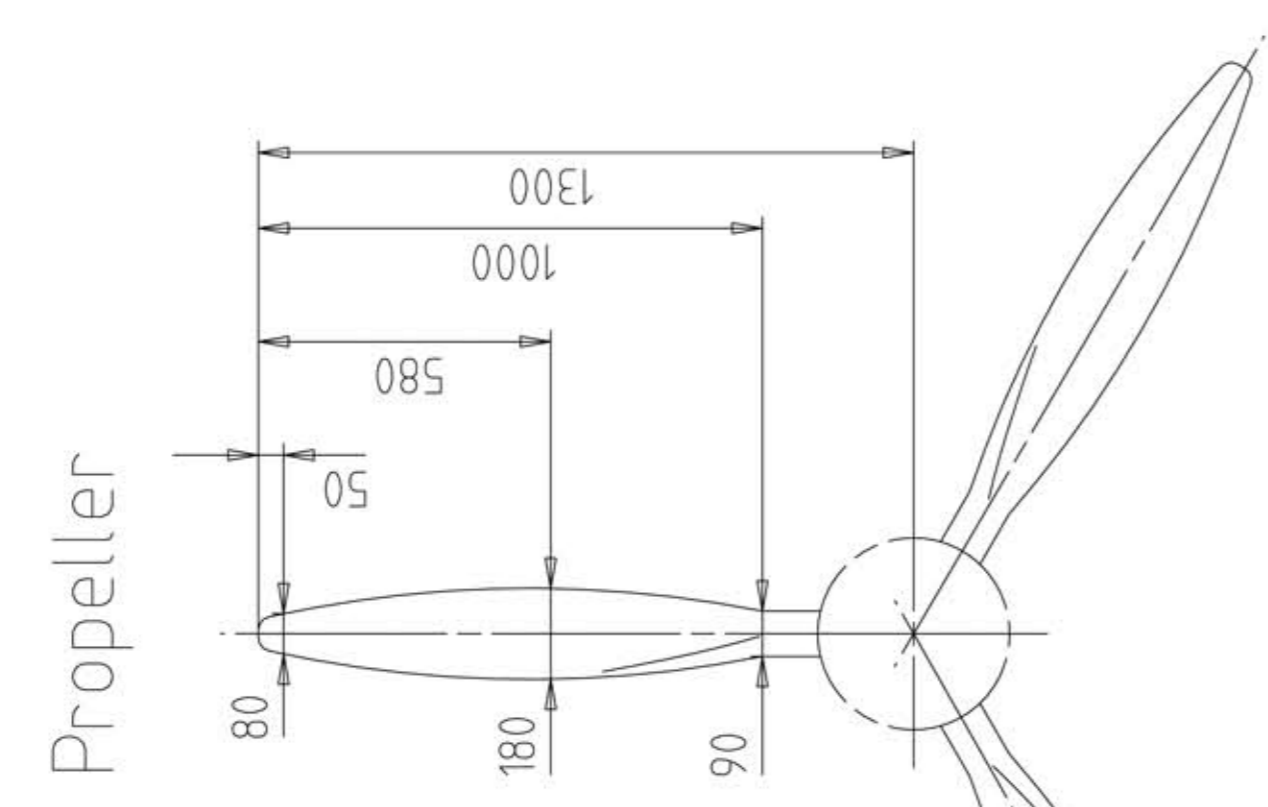
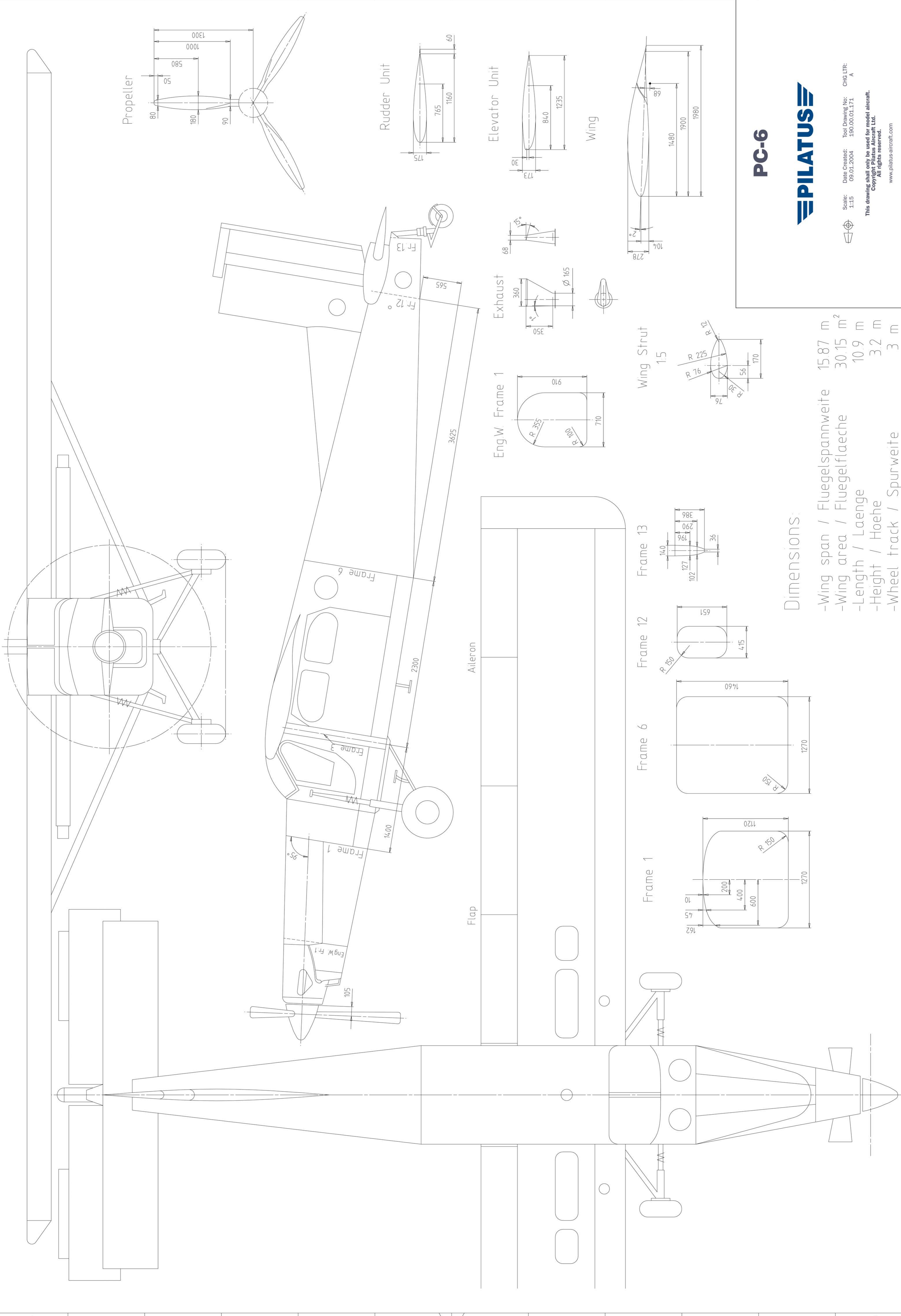

PC-6

PILATUS

Dimensions:

-Wing span / Fluegelspannweite	15.87 m
-Wing area / Fluegelflaeche	30.15 m ²
-Length / Laenge	10.9 m
-Height / Hoehe	3.2 m
-Wheel track / Spurweite	3 m

Scale: 1:15

Date Created: 09.01.2004

Tool Drawing No: 190.00.01.171

CHG LTR: A

This drawing shall only be used for model aircraft.
Copyright Pilatus Aircraft Ltd.
All rights reserved.
www.pilatus-aircraft.com

Founded in 1939, Pilatus Aircraft Ltd is the only Swiss company to develop, produce and sell aircraft to customers around the world: from the legendary Pilatus Porter PC-6 to the best-selling single-engine turboprop in its class, the PC-12, and the PC-21, the training system of the future. The latest development is the PC-24 – the world's first ever business jet for use on short unprepared runways. Domiciled in Stans, the company is certified to ISO 14001 in recognition of its efforts for the environment. The Pilatus Group includes two independent subsidiaries in Broomfield (Colorado, USA) and Adelaide (Australia). With over 2,000 employees at its headquarters, Pilatus is one of the largest employers in Central Switzerland. Pilatus provides training for about 120 apprentices in 13 different professions – job training for young people has always been a very high priority at Pilatus.

Pilatus Aircraft Ltd

P.O. Box 992
6371 Stans, Switzerland
Phone + 41 41 619 61 11
info.stans@pilatus-aircraft.com

Pilatus Business Aircraft Ltd

Rocky Mountain Metropolitan Airport
11755 Airport Way
Broomfield, CO 80021, USA
Phone + 1 800 745 2887
info.broomfield@pilatus-aircraft.com

Pilatus Australia Pty Ltd

17 James Schofield Drive
Adelaide Airport SA 5950, Australia
Phone + 61 8 8234 4433
info.adelaide@pilatus-aircraft.com

